

A PROJECT BY:



SHRUSHTI
GROUP

Come home to *Peaceful* living

HARI
SHRUSHTI
— THE WONDERFUL LIVING —

AT-BELAVALI, BADLAPUR WEST

MAHA RERA REG. NO. P51700049971

It's time to rise up to a world you *Deserve!*



SPACIOUS
1 & 2 BHK HOMES
WITH EXCLUSIVE AMENITIES



Imagine owning a home in a place that's not only futuristic but also peaceful. A place where you can finally see your dreams take shape and all those years of hard work finally pay off. A place that's exclusive and offers you an address that's truly one-of-a-kind. With all these features, you can be sure that your decision to own a home here will be a smart one.



Feel the joy of getting Together



AC Multi-Purpose Hall & Community Centre



Discover the heart of connectivity.



BADLAPUR BELAVALI SITE LOCATION MAP

Locational Advantages



SHOPING & ENTERTAINMENT

- D Mart - 400 Mtrs
- Reliance Smart Point - 800 Mtrs
- Patel's R Mart - 1.5 KM

CONNECTIVITY

- Chikhlori Station - 400 Mtrs*
- Badlapur Station - 2.7 Kms
- Panvel Highway - 700 Mtrs
- Ambernath - Karjat Highway - 0 KM

RESTUARANTS & HOTELS

- Mcdonald's - 700 Mtrs
- Pizza Hut - 700 Mtrs
- KFC - 700 Mtrs
- Domino's Pizza - 1.7 KM
- Hotel Venkeys - 300 Mtrs
- Veg Restaurant - 1 KM
- Monginis Cake Shop - 1.5 KM

EDUCATIONAL CENTERS

- Fatima High School - Adjacent
- Sunrise International School - 600 Mtrs
- Cindrella English Medium School - 2 KM

HEALTH

- Dentist - 100 Mtrs
- Pharmacy - 200 Mtrs
- Government Hospital - 300 Mtrs
- Spandan Hospital - 1.5 KM
- Ashirwad Hospital - 1.5 KM

OTHER BENEFITS

- Petrol Pump - 0 KM
- CNG Pump - 0 KM
- Car Care - 0 KM
- Sports Complex - Adjacent
- Police Station - 500 Mtrs
- SBI BANK - 1.3 KM
- ICICI BANK - 1.5 KM
- AXIS BANK - 1.9 KM
- KOTAK BANK - 1.5 KM

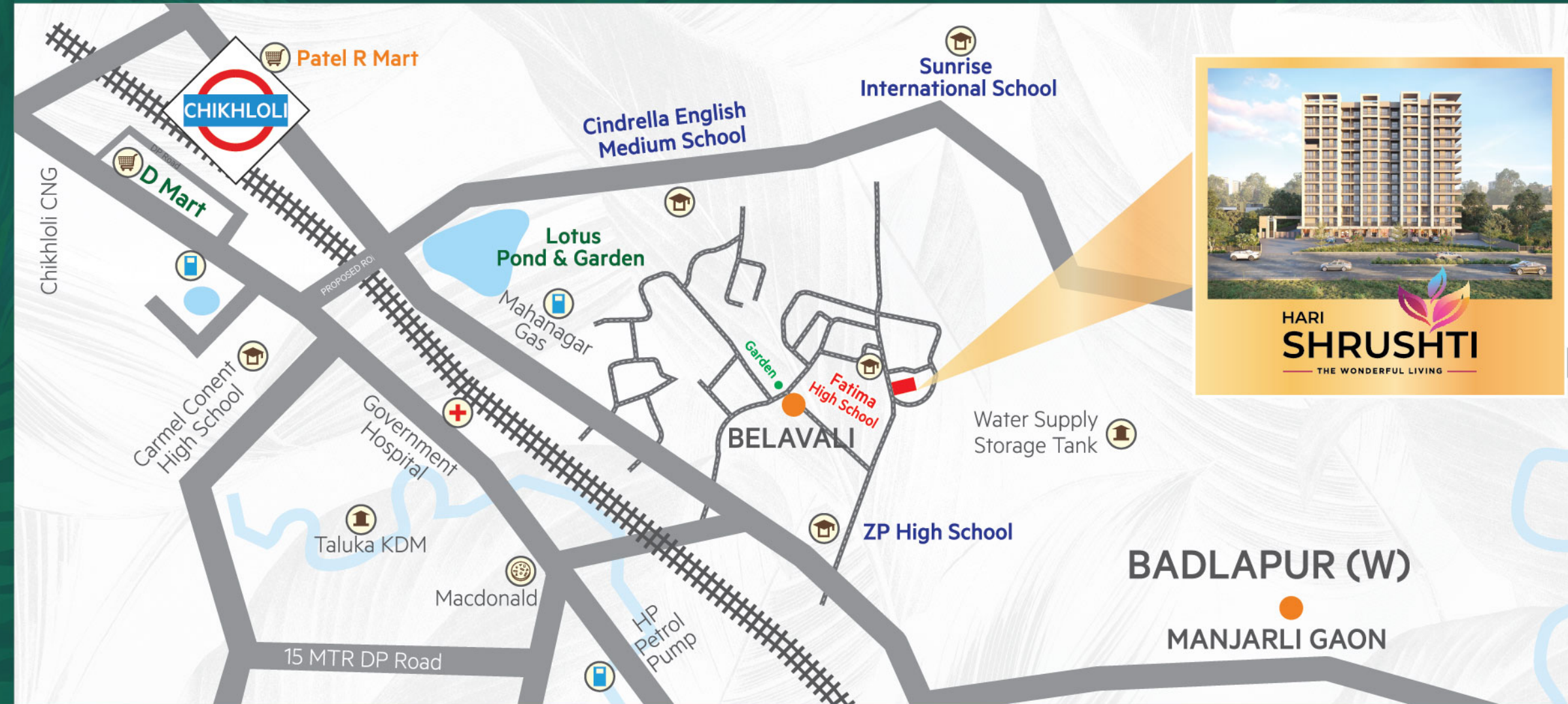



BEAUTIFUL GARDEN WITH TEMPLE

Special Features & Amenities

- | 1 BHK, 1 BHK master & 2 BHK luxurious flat
- | G+11 story
- | AC Gymnasium
- | Community Hall
- | Temple
- | Walking track
- | Skating area
- | Open MP theater area
- | Children play area with equipment
- | Gazebo with seating area
- | Land scape garden
- | Firefighting system
- | CCTV surveillance in common area
- | Branded elevator with power backup



GARDEN VIEW FROM BALCONY



HARI
SHRUSHTI
THE WONDERFUL LIVING



Rejuvenate
Recreate
Refresh...!



HARI
SHRUSHTI
— THE WONDERFUL LIVING —



**AC Gymnasium
& Fitness Centre**



The Project
Amenities

Tiles

- | Vitrified flooring tiles in all living and bedroom

Bath & WC

- | Conceal plumbing work
- | Glazed tiles upto beam level
- | Ceramic tiles flooring
- | Good quality louvers in bath & wc

Door

- | Modular Main & Internal laminates doors
- | Granites doors frame for all bath & wc



MASTER BEDROOM

Electrical

- | Conceal copper wiring with reputed branded switch tv cable points in living room

Wall Finish

- | Internal wall painted with paint
- | Exterior wall coated with paint

Kitchen

- | Granite platform with stillness steal sink
- | Granite service platform
- | Gladge tiles up to beam level above kitchen platform

Window

- | Powder coated aluminum sliding windows with glass in living room bed room kitchen

A design that prioritizes optimum use of space while ensuring abundant natural light and fresh air."



MODULAR KITCHEN



SPACIOUS LIVING ROOM



1 BHK TYPE - 1

2 BHK FLAT - 3D VIEW



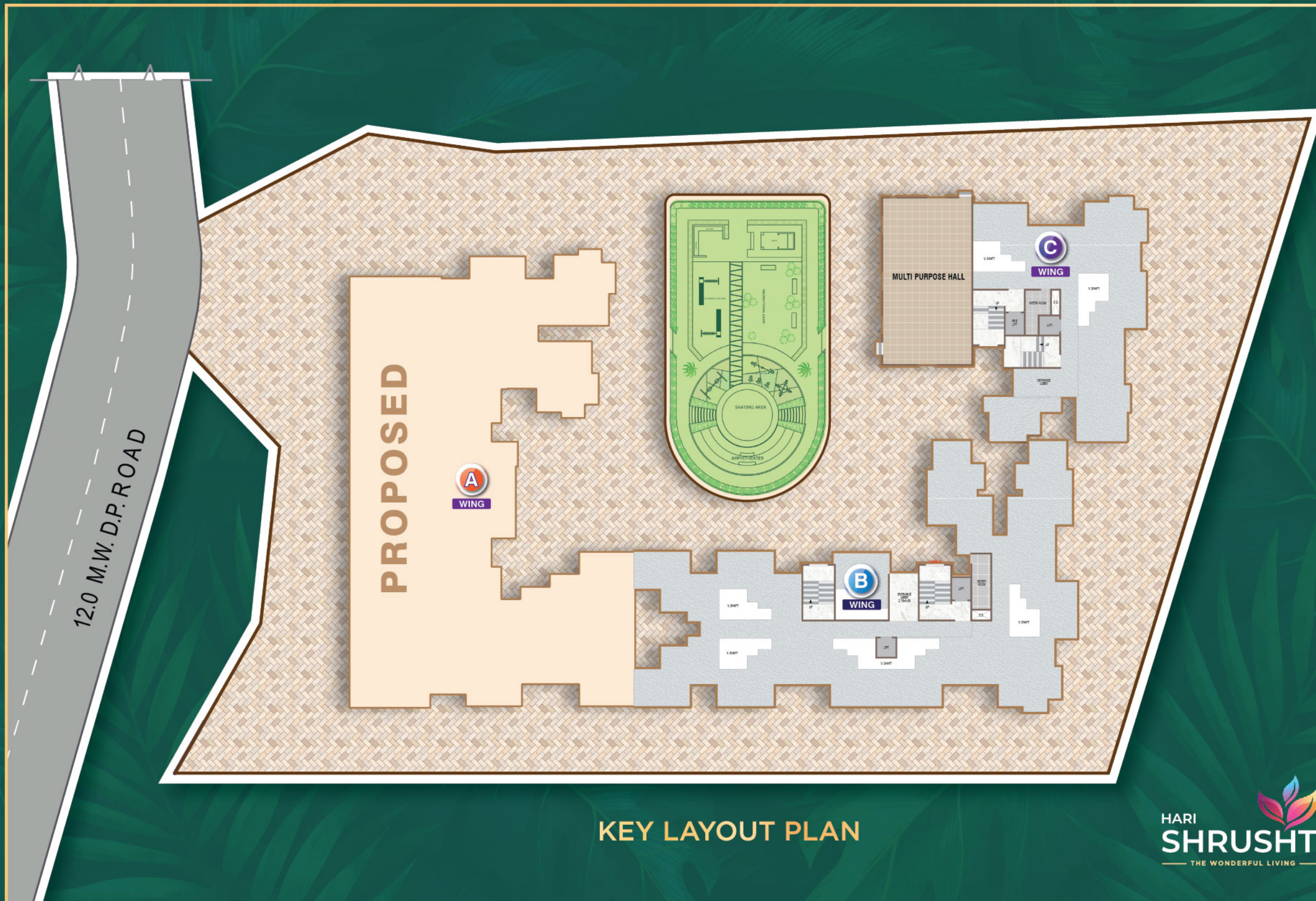



1ST FLOOR PLAN



TYPICAL FLOOR PLAN

A PROJECT BY:



SHRUSHTI
CREATORS

Site / Office:

Survey No. 105/A, H .No. 4/1, Opp. Fatima High School, Belavali, Badlapur (W) 421 503.

Email: shrushticreators1529@gmail.com

Contact for Booking: +91 96990 35005



MAHA RERA REG. NO. P51700049971
<https://maharera.mahaonline.gov.in>

Architect : **Raj & Associates** | RCC Consultant : **Aadhaar Engineers**

Note : This brochure is purely conceptual and not a legal offering. The Promoter / Architects reserve the right to add / alter any detail / specification / elevation mentioned herein. The brochure is indicative of how the furniture can be arranged in the flat. No furniture of any nature is to be supplied to the flat purchaser by the developer.